



Avenue Road, W3

Long let. Set within this new purpose-built building as part of the awe-inspiring Acton Gardens development is this sizeable two-bedroom, two-bathroom apartment with private south facing balcony with direct views onto Mill Hill Park from its vantage point on the 4th floor of the building.

- Purpose built (2019)
- Two double bedrooms, two bathrooms
- South facing balcony
- Available 15th August 2025
- Part furnished
- Secure underground allocated parking

£2,500

Wilde House

Approximate Gross Internal Area
829 sq ft - 77 sq m
(Excluding Balcony)

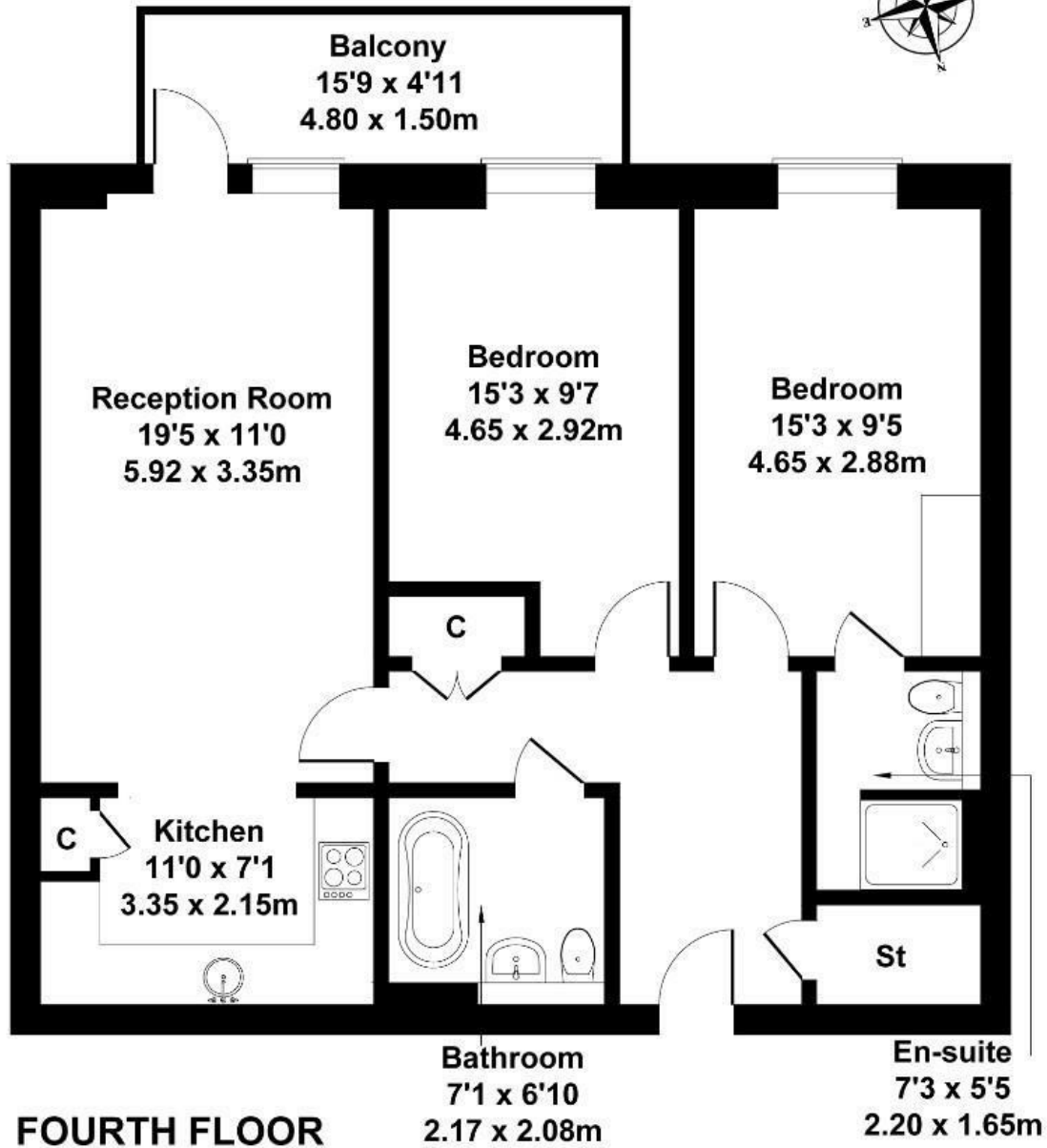

Not to Scale. Produced by The Plan Portal 2025
For Illustrative Purposes Only.

Energy Efficiency Rating		
	Current	Potential
Very energy efficient - lower running costs		
(92 plus) A		
(81-91) B	87	87
(69-80) C		
(55-68) D		
(39-54) E		
(21-38) F		
(1-20) G		
Not energy efficient - higher running costs		
England & Wales	EU Directive 2002/91/EC	